

豪华移门锁 F Series

Luxury Sliding Door Lock

配置



■ 移门锁体

- 主要材质 冷轧钢/不锈钢
- 安装范围 房门
- 安装中心距 35mm
- 执行标准 QB/T2474-2000 GB21556-2008
- Material Cold Rolled Steel/stainless Steel
- Available for Room door
- Installation center distance 35mm
- Execute standard QB/T2474-2000 GB21556-2008

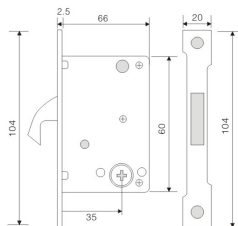

■ 移门锁普通3匙

- 主要材质 锁芯、钥匙均采用59黄铜
- 表面处理 扫金、扫镍
- 锁芯配置 锁芯标配高精密弹珠, 3条普通钥匙
- 特殊性能
- 执行标准 QB/T2474-2000 GB21556-2008
- Material Cylinders and keys all use high quality 59# yellow bronze
- Finish Satin Gold Satin nickel
- Installation Center Distance High precision keys with anti-picking and anti-drilling designs
- Execute Standard QB/T2474-2000 GB21556-2008

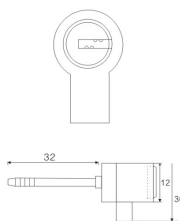

■ 普通3匙（工程锁用）

豪华移门锁F系列

Luxury Sliding Door Lock

YALIS® 雅丽斯®
—— 艺术门锁 · 五金 ——

产品透视图

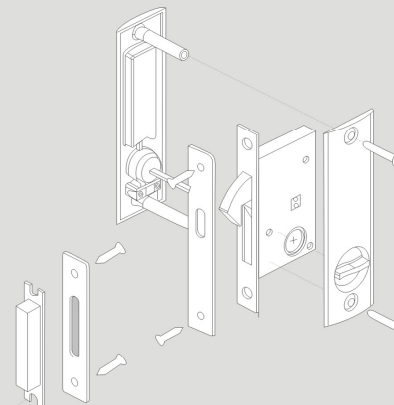

适用功能

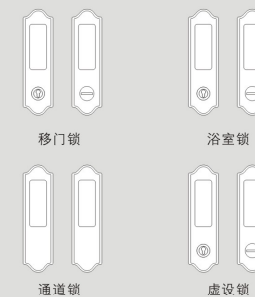

功能特点

- 外观设计：当下流行现代简约风，线条雅致，纹路简单大方，色彩亮丽，尽显家居品质，美观时尚，符合现代生活观念。
- 手感：符合人体工程学，手感舒适。
- 锁体：正常使用寿命超过20万次开合。
- 锁头：锁胆、锁芯、钥匙均选用优质黄铜，7珠弹子结构使复开率更低。
- 电镀工艺：引用意大利电镀工艺，表面7层电镀，抗腐蚀能力更强。
- 锁具结构：内部结构合理，使得执手左右互换更加方便。

技术参数

- 主要材质 锌合金
- 安装范围 木门、金属门
- 安装门厚 35mm-50mm或特殊定做
- 锁体型号 移门锁-锁体
- 锁芯型号 普通匙3条
- 门锁类别 弹子插芯门锁
- 执行标准 QB/T2474-2000 GB 21556-2008
- 门边距 35mm

The Function Instruction

- Appearance design: modern fashion style, elegant but generous lines. Bright colors and beautiful shape reflect home quality. It is in line with the concept of modern life.
- Touching: The whole design is based on ergonomics, give you a comfortable touch.
- Lock body: can open and close for more than 200,000 times when use it in normal way.
- Lock: cylinder and keys all use high quality yellow bronze material, using 7 marbles beads structure to low its re-opening rates.
- Electro-plating technology: Use Italy electro-plating technology, 7 layer electro-plating to enhance its corrosion ability.
- Locks structure: legitimate inner structure, it is more convenient to change handle in left side or right side

Technical parameters

- Material Zinc-alloy
- Available for Wooden Door, Metal Door
- Door thickness 35mm-50mm or Special Order
- Lock body Sliding-door lock body
- Cylinder 3 keys
- Classification Door Lock
- Standard QB/T2474-2000 GB 21556-2008
- Backset 35mm



豪华移门锁F系列 Luxury Sliding Door Lock



扫金间镍 SN/NP



F138

扫金间金 PB

品类：弹子插芯门锁
主要材质：锌合金
适用范围：木门、金属门
锁头：普通3匙
锁体：移门锁体

Products: Mortise Lock
Material: Zinc Alloy
Available for: Wooden doors / Metal doors
Cylinder: Ordinary 3 Keys
Lock body: Sliding door mortise lock

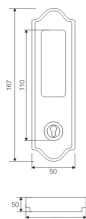

扫金间金 PB



F158

扫镍间镍 SN/NP

品类：弹子插芯门锁
主要材质：锌合金
适用范围：木门、金属门
锁头：普通3匙
锁体：移门锁体

Products: Mortise Lock
Material: Zinc Alloy
Available for: Wooden doors / Metal doors
Cylinder: Ordinary 3 Keys
Lock body: Sliding door mortise lock

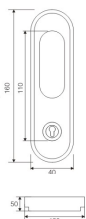

扫镍间镍 SN/NP



F168

扫金间金 PB

品类：弹子插芯门锁
主要材质：锌合金
适用范围：木门、金属门
锁头：普通3匙
锁体：移门锁体

Products: Mortise Lock
Material: Zinc Alloy
Available for: Wooden doors / Metal doors
Cylinder: Ordinary 3 Keys
Lock body: Sliding door mortise lock

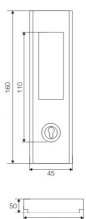

室内房门锁 KS Series Bedroom Door Lock

配置



■ 4550双舌插芯锁体系列

- 主要材质：冷轧钢/不锈钢
- 安装范围：房门
- 锁体中心距：50mm
- 安装中心距：45mm
- 执行标准：QB/T2474-2000 GB21556-2000
- Material：Cold Rolled Steel/stainless Steel
- Available for：Room door
- Lock body center distance：50mm
- Installation center distance：45mm
- Execute standard：QB/T2474-2000 GB21556-2008

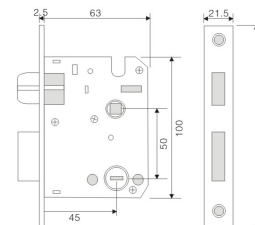

■ 6珠单排电脑锁头4匙

- 主要材质：锁芯、锁壳、钥匙均采用59黄铜
- 表面处理：青古铜、黄古铜、红古铜、扫金、扫镍
- 锁芯配置：锁芯标配6粒高精度弹珠，4条电脑钥匙
- 特殊性能：高精度电脑匙设计，具有防钻防撬性能
- 执行标准：QB/T2474-2000 GB21556-2008

- Material：Cylinders and keys all use high quality 59# yellow bronze
- Finish：Antique Brass, Yellow Antique Brass, Antique Copper, Satin Gold

- Cylinder Configuration：Six Marbles Beads Structure With Four Computerized Keys

- Installation Center Distance：High precision computerized keys with anti-picking and anti-drilling designs

- Execute Standard：QB/T2474-2000 GB21556-2008

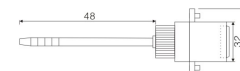
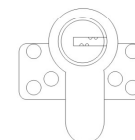
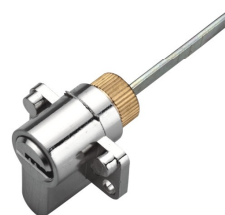

■ 电脑4匙挂铬